

PACKAGE CONTAINS

1. Swing Pad
2. Type-C charging cable
3. User's Manual

SPECS

Dormant Current	Less than 27uA
Pairing Current	30~60Ma
Working Voltage	3.7V
Current	25mA-150mA
Input Voltage	DC4.5~5.5V
Input Current	600mA
Bluetooth Version	2.1+EDR

PRODUCT BRIEF

This is a Bluetooth wireless controller which is used with NSW console; the console can be awakened with one key; it supports motor vibration and adjustment, manual turbo, automatic turbo and turbo speed adjustment. It can also be used on PC (PC x-input functions)

OPERATION GUIDE

» DESCRIPTIONS OF MODES AND CONNECTION:

NSW mode connection: Long press Home button for 3 to 5 seconds and the LED will flash quickly to enter the Bluetooth mode. After it is connected, corresponding channel indicators will be always on. Note: After the controller enters the synchronous mode, it will go to sleep mode automatically when it is not synchronized successfully within 2.5 minutes.

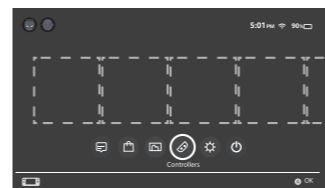

1. Enter the controller setting page according to the following steps.

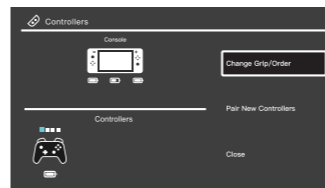

2. Enter the page to switch the controller mode.

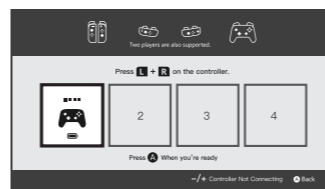

3. Open the controller according to instructions of (initial use) and enter the connection state. It works after connection successfully.

» RECONNECT AND WAKE-UP:

Reconnect:

When the controller is in sleep mode, press any button (such as A, B, X, Y, [+], [-], O, ↑, ↓, ←, →) and the LED1-LED4 will flash. Now the controller will connect with console automatically.

Wake-Up:

When the controller is in sleep mode, short press the home button and the LED1-LED4 will flash. Now you wake up the console and the controller will be connected automatically.

» DORMANT STATE AND DISCONNECTION:

If the console screen is off, the controller will enter the dormant state automatically. If no button is pressed within 5 minutes, the controller will enter the dormant state automatically (the sensor does not work). In the wireless connection state, you can press HOME Button for 5 seconds to disconnect.

» CHARGING INDICATION:

During the shutdown state, if the controller is charged, LED1-LED4 will flash slowly; if it is fully charged, LED light will be off; During the connection state, if the controller is charged, current channel indicator will flash (slow flashing). The current channel indicator will be always on when the controller is fully charged.

» LOW VOLTAGE ALARM:

When the battery voltage is too low, it will change to sleep mode automatically.

Low voltage alarm: The current channel indicator flashes (flash quickly).

» TURBO FUNCTION:

A: Manual Turbo Setting:

(First Time) Press one of the button (A, B, X, Y, L, R, ZL, ZR) and then press TURBO button to for the TURBO function.

B: Automatic Turbo Setting:

(Second Time) Press the button with manual Turbo function again and then press "TURBO" button to start the automatic TURBO function.

C: Clear TURBO Setting:

(Third Time) Press the button with automatic TURBO function again and then press "TURBO" button to clear the TURBO function.

D. Clear all TURBO:

First press and hold the TURBO button for more than 3 seconds and then press the "-" button to clear the TURBO function.

» WIRED CONNECTION:

PC Connection:

Please use a USB cable to connect the controller and the computer. The controller LED3 will be always ON after connection. (Note: The default mode of the controller under PC is X-INPUT mode)

NSW Connection:

Please use a USB cable to connect the controller and the SWITCH console. After connection, the corresponding LED of the controller will be always ON.

» RGB DAZZLING LIGHT:

When the controller is turned on, the dazzling light will be set by default and the 8 colors of blue, red, green, yellow, green, orange, purple and pink will be set circularly.

Continuously press T Button for 3 times to turn off the dazzling light and then press T Button for 3 times to turn on the dazzling light.

» MOTOR VIBRATION SPEED ADJUSTMENT (FOR NSW ONLY):

When the controller is well connected, press L, R, ZL and ZR buttons simultaneously to adjust the motor intensity (the controller will vibrate once of each time when you adjust it);

The motor vibration can be divided into three levels, "strong => medium => weak". The "medium" level is the default level, followed by "strong" and "weak". The rest can be done in the same manner.

» M BUTTON FUNCTION PROGRAMMING

M button= M1, M2, M3, and M4; buttons that can be programmed include ↑, ↓, ←, →, A, B, X, Y, L, R, ZL, ZR, L3, R3.

Close M Button Function:

Turn the Mode Switch to the middle to close M Button function.

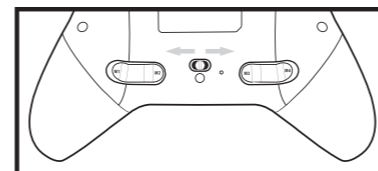

Normal Mode:

Shift the Mode Switch to the right of (M2 direction), M1 for X, M2 for Y, M3 for B, M4 for A. (Note: It cannot be programmed during normal mode)

Programming Mode:

1. Shift the Mode Switch to the left of (M3 direction). M1 for ZR, M2 for R, M3 for L, and M4 for ZL.

2. Setting Method: Press M Button; then, press "[+]" Button and the indicating light will flash.

Then, release it to enter programming. Then, press any one of the button (↑, ↓, ←, →, A, B, X, Y, L, R, ZL, ZR, L3, R3) and M button to save the setting.

3. Press M1 Button, M4 button and "-" button at the same time for three seconds and the LED will flash once to restore the default.

For example, press M1 Button and press "+" Button to set the programming (the LED flashes once). Press A button and M1 button to save the setting. At this point, M1 Button corresponds to A button function.

Note: When entering the program, if you do not press the button which can set the programming, the originally set functions will be cleared.

» RESET CONTROLLER HARDWARE:

In case of abnormal situations of the controller, please press HOME button for more than 10 seconds to reset the controller hardware.

» SAFETY INSTRUCTIONS

- Do not expose the device to direct sunlight or temperatures above 40 or below 0 degrees Celsius.
- Do not hold the unit directly or near naked flames such as candles or similar.
- Do not use or charge the unit during a thunderstorm.
- Do not allow the unit to come into contact with liquids, moisture, or dust. Do not use water, alcohol, or chemicals to clean the unit. Before cleaning the unit, remove the unit from the power source.
- The unit must not be thrown or dropped, as permanent defects may occur.
- Please do not attempt to open the unit or attempt to repair it yourself. Instead, contact the dealer or a qualified technician.
- Keep the unit and accessories away from small children or animals that could swallow small parts!

» SUPPORT

FlashFire Interactive Inc.
Taiwan office:
8F, No. 14, Ln.609, Sec. 5, Chongxin Rd., Sanchong Dist., New Taipei City 24159, Taiwan. Tel: +886-2-2278-1500

» WARRANTY

This product has been given a 1- year warranty by FlashFire Accessories INC. from the date of purchase. Should a defect occur during this period due to faulty materials or workmanship, the dealer from whom you purchased the device will replace your device with an identical or similar model upon presentation of proof of purchase. This warranty does not apply to defects resulting from accidental damage or misuse. Local legal regulations are not affected by this.



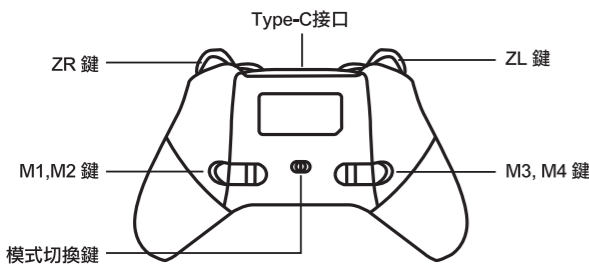
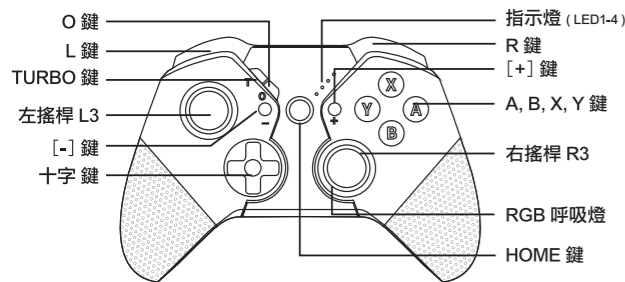

包裝內容

1. 藍牙手柄
2. Type-C 充電線
3. 說明書

規格

休眠電流	小於27uA
配對電流	30~60Ma
工作電壓	3.7V
工作電流	25mA-150mA
輸入電壓	DC4.5~5.5V
輸入電流	600mA
藍牙版本	2.1+EDR

產品概述

本產品為藍牙無線手柄；主要與NSW主機搭配應用；支持一鍵喚醒主機；支持馬達振動及調節；支持Turbo手動連發，自動連發及連發速度調節；支持在PC主機使用（實現PC X-INPUT功能）。

操作指引

》 模式與連接說明:

NSW模式首次連接：長按Home鍵3-5秒後，LED跑馬燈快閃進入藍牙搜索模式，連接成功後對應的通道指示燈常亮。注意：手柄進入同步模式後，2.5分鐘之內沒有同步成功則自動休眠。

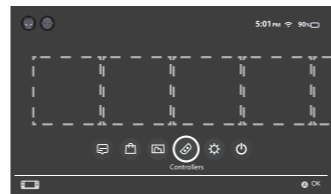

1. 按下主畫面”控制器”選項

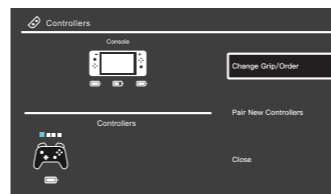

2. 選擇”更改拿法 / 順序”

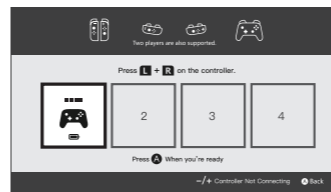

3. 長按Home鍵3-5秒後，LED跑馬燈快閃進入藍牙搜索模式，等待連接成功。

》 回連與喚醒:

回連：

手柄休眠狀態下，按（A. B. X. Y. [+]. [-]. O. ↑. ↓. ←. →）任意一個按鍵LED1-LED4跑馬燈，自動回連主機。

喚醒：

主機休眠狀態下，短按手柄HOME鍵LED1-LED4跑馬燈閃爍，即可喚醒主機，手柄自動與主機連接。

》 休眠與斷開:

1. 若主機螢幕關閉，手柄則自動休眠。
2. 5分鐘之內沒有任何按鍵按下則自動休眠(包括感測器不動)。
3. 無線連接狀態下，按下HOME鍵5秒，斷開與主機連接。

》 充電指示:

1. 手柄關機下，充電時LED1-LED4慢閃，充滿電時LED燈熄滅。
2. 連接狀態下充電，當前通道指示燈閃爍(慢閃)，充滿電當前指示燈常亮。
3. 配對、回連、充電或低電時，會以配對及回連LED指示優先。

》 低電壓燈號警示:

1. 電池電壓過低時則自動休眠。
2. 低電壓燈號警示：當前通指示燈閃爍(快閃)。

》 TURBO功能:

A: 手動連發設置：

(第一次)任意按(A. B. X. Y. L. R. ZL. ZR)一個或幾個動作鍵，再按TURBO鍵，開啟手動連發功能。

B: 自動連發設置：

(第二次)再次按下已開啟手動連發功能的動作鍵，並再按TURBO鍵，開啟自動連發功能。

C: 清除連發設置：

(第三次)再次按下已開啟自動連發功能的動作鍵，並再按TURBO鍵，清除連發功能。

D: 清除所有連發：

按住TURBO鍵3秒以上再按“[-]”號鍵，清除所有按鍵的TURBO功能。

TURBO速度調節：

T鍵與十字鍵上(UP)是加快速度；T鍵與十字鍵下(DOWN)是減慢速度，速度分為8HZ,12HZ,15HZ；默認為12HZ。

》有線連接:

PC端連接：

請使用USB線連接手柄和電腦，連接後手柄LED3閃爍。(注意：手柄在PC端預設X-INPUT模式)

NSW連接：

請使USB線連接手柄和NSW主機並開啟有線手柄選項，連接後手柄上對應的LED燈常亮。

》 RGB呼吸燈:

當手柄開機時默認打開呼吸燈，由藍、紅、綠、黃、青、橙、紫、粉8種顏色進行迴圈呼吸；連續按T鍵3次關閉呼吸燈，再連續按T鍵3次打開呼吸燈。

》 震動速度調整(僅針對NSW):

在連接狀態下，同時按住L,R,ZL,ZR四個鍵，進行馬達強度調節(調節一次手柄會震動一次)；馬達震動分為強中弱3個級別，每次使用都默認為中，然後是強、弱這樣的方式進行循環。

》 M鍵功能程式設計:

M鍵=M1.M2.M3.M4；可設定編程的按鍵↑. ↓. ←. →. A. B. X. Y. L. R. ZL. ZR. L3. R3。

關閉M鍵功能:

模式開關撥至中間關閉M鍵功能。

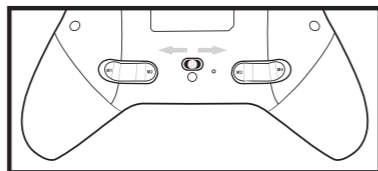

正常模式:

模式開關撥至(M2方向)右邊，M1映射X,M2映射Y,M3映射B,M4映射A。(注意：正常模式下不可程式編程)

編程模式(巨集模式):

1. 模式開關撥至(M3方向)左邊，默認M1映射ZR,M2映射R,M3映射L,M4映射ZL。
2. 設置方法：按住M鍵不放，再按“[+]”鍵指示燈閃一下再放開後進入編程模式，再任意按一個或幾個想要設置的按鍵(↑. ↓. ←. →. A. B. X. Y. L. R. ZL. ZR. L3. R3)，再按M鍵保存設置完成。
3. 同時按住M1鍵、M4鍵、[-] 鍵，三個按鍵3秒後指示燈閃一下恢復預設值。

例如：按住M1鍵不放，再按“[+]”鍵進入編程模式設置(指示燈閃一下)，再按下A鍵，再按M1鍵保存設置完成，此時M1鍵對應的就是A鍵功能。

注意：在進入編程模式中，若未按下任一可被編程之按鍵，原設置的按鍵將會被清除。

》 手柄重新設定:

當手柄出現異常時，長按HOME鍵超過10秒，手柄重新設定。

》 注意事項:

- 請勿將設備暴露在陽光下或高於攝氏40度或低於攝氏0度的溫度下。
- 請勿將本機直接放在靠近火源處，如蠟燭或類似物品附近。
- 雷雨期間請勿使用或充電。
- 請勿使本機接觸液體，濕氣或灰塵。
- 請勿使用水、酒精或化學藥品清潔設備。
- 在清潔本機之前，請從電源上拆下本機。
- 請勿扔擲或摔落本機，否則可能會造成永久性缺陷。
- 請不要嘗試打開設備或嘗試自行維修。
- 使本機和配件遠離可能吞食小零件的小孩或動物！

》 聯絡我們:

24159新北市三重區重新路五段609巷14號8樓
Tel: +886-2-2278-1500

》 保固:

自購買日起，該產品已獲得「FlashFire當雷迅」的一年保固。如果在此期間有瑕疵或新品不良，請至購買的經銷通路出示購買證明，將會為您服務。
★不適用於因意外損壞或人為導致的損壞★



WWW.FLASHFIRE.TW